

**241** Solitude  
GAIA

**GAIA**

Guest Information  
Booklet



# CONTENTS

04	Solitude Gaia
07	Vessel Facts
08	Safety
09	Safe Diving
12	The Diving Specifications
14	Onboard Hospitality
16	About the Cabins
21	The Digital Area
22	Palau
26	Solitude Gaia Itineraries
28	Classic Palau 8 Days 7 Nights
32	Palau New / Full Moon Spawning
34	Palau 11 Days 10 Nights
38	Deep South Palau Expedition 12 Days 11 Nights
42	Solitude World
47	Connect With Us & Keep in Touch
48	Returning Guest Privileges
50	Join Our Community







# SOLITUDE GAIA

A scuba diving liveaboard that transforms the core experience of exploring and adventuring on the open ocean.

Completed in the year 2023, this vessel, stretching an impressive 40 metres in length, is more than just a ship; it's a testament to innovation and meticulous craftsmanship. With a robust steel hull, it stands as a symbol of stability, ensuring your safety and peace of mind throughout your diving journey. But that's not all; the Solitude Gaia's aluminium superstructure adds a unique touch, not only contributing to its stability but also lowering the centre of gravity for an even more secure and comfortable voyage.

What sets the Solitude Gaia apart is not just its structural excellence but also its deep commitment to creating an environment where guests can truly feel at home. Designed to meet the highest standards of the classification society BKI and the stringent requirements for a passenger ship, it was crafted with the intent to share the profound passion and wonder of the world beneath the ocean's surface.

Stepping on board, you'll find that the Solitude Gaia exudes a feel and vibe that inspire freedom of the mind and a sense of openness. It encourages reflection on the timeless virtues

that guide our lives: humility, charity, chastity, gratitude, temperance, patience, and diligence. These virtues are not just words; they are embedded in the very essence of the vessel, shaping your experience.

The curated décor, with its soothing neutral tones, offers a space that exudes consideration, intent, comfort, elegance, and a subtle touch of luxury. It's a deliberate choice, designed to reinforce gratitude and appreciation for the remarkable world that lies beneath the waves.

With a cruising speed of 10 knots, Solitude Gaia offers a sense of serenity and adventure combined. It boasts nine cabins and a sumptuous spa suite, ensuring the utmost comfort for up to 18 guests. As you embark on your scuba diving journey aboard this remarkable vessel, you'll not only explore the ocean's depths but also embark on a voyage of self-discovery, where the virtues of the sea and the vessel itself converge to create an experience like no other.





# VESSEL FACTS

Solitude World, a privately held company headquartered in Singapore, oversees the operations of the impressive Solitude Gaia, which proudly stands as the third vessel within the Solitude Fleet.

<b>Type and Year Built</b> Steel Mono-Hull with aluminium superstructure, launched in 2023.	50KW/62.5KVA 3PH 50Hz generators providing 24 hours of 200V to 240V - 50Hz power.
<b>Port of Registry/Flagged</b> Indonesia	<b>Navigation</b> equipped with local navigation maps, GPS chart plotter, radar (long/short range), weather plotter, and depth sounder.
<b>Cruising Itinerary Routes</b> Philippines	<b>Communication System</b> VHF/SB radios, VSAT satellite phone & internet.
<b>Length</b> 40m (meters) <b>Beam</b> 9m <b>Draft</b> 2.3m or <b>Length</b> 131.24ft (feet) <b>Beam</b> 29.53ft <b>Draft</b> 7.55ft	<b>Ship Safety System</b> GMDSS with EPIRB, AIS, life rafts, emergency survival packs, and a semi-automated fire suppression sprinkler system.
<b>Cruising Speed</b> 10 Knots, top speed 14 Knots	<b>Fresh Water Capacity</b> 63,086L (storage) with 3 onboard water-makers each capable of producing 280L of fresh water per hour.
<b>Diesel Capacity</b> 62,256L (16,459.25 US Gal.)	
<b>Cruising Range</b> is approximately 9000 nautical miles (16,668 km).	
<b>Engine &amp; Propulsion</b> twin Yanmar engines 829 HP @ 1900 RPM.	
<b>Electricity</b> 2 x Baudoin 6W105S rated 107KW-1500RPM and 1 x Weichai WP4CD66E200	





# SAFETY

SAFETY is Solitude's top priority, we take every precaution to ensure the safety of our guests and crew. As we operate in remote areas we ensure that we are well-equipped to handle any emergency scenario.

During your stay onboard we provide our guests with a complimentary Nautilus Marine Rescue GPS to provide that peace of mind when out diving in the remote parts of Palau and the Philippines.

Our Features & Global Maritime Distress and Safety System (GMDSS) equipped with:

- Emergency Position-Indicating Radio Beacon (EPIRB)
- Life Rafts
- Emergency Survival Packs
- Semi-Automated Fire Suppression Sprinkler System
- VHF/SB Radios
- VSAT Satellite Phone & Internet
- Inmarsat-C
- Local Navigation Maps with Furuno GPS Chart Plotter
- Radar (Long/Short)
- Weather Plotter
- Depth Sounder
- 63,086L Water Storage with On-board Water-Makers capable of producing 280L of fresh water per hour.



# SAFE DIVING

We understand that your time and investment in a holiday are valuable, and we aim to provide you with as many dives as possible while ensuring your safety.

To prioritise safety, we require a minimum of 6 hours of rest before your first dive this will ensure that you are well-rested and hydrated before your first dive.

We recognise that although you have learned about safety during your scuba course/s, the excitement and anticipation of a diving holiday can sometimes cause us to neglect our own readiness for a dive.

Our crew's safety is also important, so we limit the number of dives to four per day, including a night dive, to minimise fatigue and reduce the risk of accidents.

Itineraries are subject to change due to weather and logistics, but our cruise directors will keep you informed.

**Dive Site: Jake Seaplane**





# THE DIVING SPECIFICATIONS

We aim to provide you with as many dives as possible while ensuring your safety.

**Dive Skiffs** there are two purpose-built aluminium boats measuring 6m each, equipped with single 100HP out-board engines.

**Support Skiff** purpose-built aluminium boat measuring 6m, equipped with single 100HP outboard engine.

**Air Compressors** 3 x Bauer Poseidon compressors

**Nitrox Membrane System** Aaragon

**Dive Guides** ratio 1 to 6 divers. Private guide service is available with advance notice for USD150 per diving day (pdd).

**Dive Equipment Rental** is available, which includes dive computers, but underwater cameras are not included.

**Nautilus Lifeline MARINE Rescue** is complimentary Nautilus Lifeline Marine Rescue GPS. Please Note, that if you use the Device, you are responsible for replacing it if lost or damaged.

**Surface Marker Buoy (SMB), Lead Weights & Belt** are complimentary but responsible to replace if lost or damaged.

## YES%

### Enriched Air Nitrox

Enriched Air Nitrox is exclusively offered to certified divers. Our proficient dive team will determine the blend, approximately between 28-32%, considering the MOD, dive site, its profile, and target species, ensuring the best opportunity for a safe and optimised diving experience.

### Dive Shop

On-board, you can purchase Surface Marker Buoy (OPV, SOLAS Reflector), Nautilus Lifeline GPS/VHF Radio (with Pouch), Spools, Dive Pointers, Drift Hooks, o-rings, Hoses, and other common replaceable spares. We recommend placing an advance order, as quantities are limited.

Prior to diving, it is mandatory to present proof of certification and dive insurance.

**Enriched Air Nitrox Diving** EANx 28 to 32%, to provide a more suitable M.O.D for divers.

**Scuba Cylinders** of various DIN sizes (York Adaptors available). Twin tanks are not available, side-mount friendly. Rebreather Support only on full charters with rebreather divers. Organising scrubbers requires advanced notice of 60 days or more, although there is no guarantee. Alternatively, you have the option to order and send them to us. It's important to note that oxygen supply in Palau is both limited and costly.

**Medical Oxygen and Comprehensive First Aid Kits** are available

**NO SOLO** diving is allowed, even if you are certified.

**It is mandatory for all guests** engaging in scuba activities to have an audible signalling device (such as a whistle), a dive computer, a surface marker buoy, appropriate dive insurance coverage, a valid dive certification, and have completed waiver Form A and C for the activities.

### Dive Centre

EANitrox prices are as follows: USD8 per dive OR		
1	USD135 for 8D/7N and 7D/6N itinerary, with subsequent additional use USD20 per day	Yes
2	100 cu.ft. / 15L cylinders - additional charge USD10 per cylinder per diving day (pcpdd)	Yes*
3	Side mount support - additional 12L/80cu.ft. cylinder and twin tank 12L/80cu.ft. available. Air USD10, EANitrox USD28 pcpdd. Whole trip use: 10% discount applies	Yes*
4	DIN valves with option of Yoke (A-clamp)	Yes
5	Rebreather diving costs only USD0.06 per litre* for oxygen filling. Dive profiles must consider other guests' comfort and safety. Complete support, including Twin Tank configurations, is available for full charters. Helium, if required, may be costly. Full charter profiles are not limited to standard recreational limits.	Yes
6	Rental gear available	Yes*
7	Private Guide Service is available for USD150 pdd.	Yes*

\* Subject to availability/change





# ONBOARD HOSPITALITY

Welcome aboard Solitude Gaia,  
where our exceptional hospitality  
ensures a journey of tranquillity  
and comfort unlike any other.



**Entertainment onboard** entertainment includes smart TVs installed in every cabin, lounge, and dining area. The lounge features a Bose audio system designed to elevate your viewing experience, complementing the 65-inch smart TV. Additionally, guests have access to cards and board games for their leisure and enjoyment.

**Types of Coffee Available onboard**, there is a fully automatic (self-service) ground coffee machine, local and instant coffee.

**Types of Tea Available onboard**, we maintain a diverse selection that includes Chamomile, English Breakfast, Ginger, Green, and Chinese teas, subject to availability.

**Drinking Water free flow** from potable water dispenser with additional 4-stage filtration.

**Alcoholic Beverages Available\*** beer, red/white/rose wine, and popular liquors, you may also BYO (at a reasonable amount (i.e. Philippines or Palau

duty-free allowance) with no corkage charge. We do not allow any request to assist in personal purchases to stock alcoholic beverages as we conduct sales of alcoholic beverages on board. Non-alcoholic Beverages are subject to availability, popular selections include light and zero options.

**Self Serve Snacks** are available 24 hours. Ice Maker available.

**Special Dietary Requests** with prior notice, we can cater to vegetarian and selective non-meat diets. However, for vegans, we kindly request advanced notice and a specific list of allowable ingredients for their meal preparation.

**Souvenirs\*** Solitude Gaia apparel are still in progress, however, local souvenirs can be purchased when we take you to the local shopping mall.

**Onboard Guest Services\*** satellite internet and laundry services are available.



# ABOUT THE CABINS

The cabins are thoughtfully designed, inspired by years of experience and guest feedback, incorporating essential elements.

Step into Solitude Gaia, where luxury and adventure meld seamlessly. With nine (9) meticulously designed cabins accommodating up to 18 guests, the vessel mirrors thoughtfulness, elegance, and opulence. Each cabin, a tranquil oasis on the open sea, epitomises relaxation and sophistication. Neutral tones and graceful furnishings create a timeless ambience, fostering reflection and rejuvenation.

These spaces embody Solitude Gaia's unwavering commitment to excellence, offering a spacious and inviting environment where you can unwind, connect with fellow travellers, and reconnect with yourself. It's a world where the tranquillity of the sea harmoniously coexists with the luxury of life aboard Solitude Gaia during your voyage.

## OVERVIEW - 9 Cabins in Total

**Upper Deck** | 3 cabins in total, 303, 302, 301: 2 x Ocean View Staterooms (2 Twin or Double Sharing), 1 x Ocean View Cabin (Double Sharing)

**Main Deck** | 4 cabins in total, 204, 203, 202, 201: 4 x Ocean View Cabins (2 Twin and Double Sharing)

**Below Deck** | 2 cabins in total, 102, 101: 2 x Interior Cabins (Twin or Double Sharing)

### Mattress Sizes

- King Mattresses 198cm x 202cm (Cabins 201 and 202)
- King Mattress 182cm x 202cm (Cabin 303)
- Single/Twin Mattresses 102cm x 202cm or 204cm x 202cm (Cabins 301, 302, 203, 204)
- Single/Twin Mattresses 100cm x 198cm or 200cm x 198cm (Cabins 101 and 102)

### En-suite

Every cabin and stateroom on board is equipped with an en-suite shower (providing both hot and cold water) and a WC featuring a common water-flush system.)

### Cabin Comforts

- Individual air conditioning system with climate control



- A safe deposit box
- Bathrobes, face and bath towels
- Hair dryer
- Intercom
- Television
- Body wash, Shampoo and Conditioner
- Bedding including pillows, duvet, and sheets. Extra pillows and light blankets are available on request
- Wardrobe organiser with ample hangers
- Desk with universal electrical points conveniently located for gadgets

### En-suite Shower and Toilet

The cabin en-suite showers and toilets are thoughtfully designed to cater to the needs of modern-day users. While the size may vary depending on the cabin category, even the most compact cabins provide sufficient room, shelving, and space to accommodate your personal toiletries. All en-suite facilities are equipped with the following amenities:

- Manual bidet gun
- Separate shower
- Shelves, robe hooks and towel hanging space

### Housekeeping Practice

Cabins are cleaned daily. Sheets, bath and face towels are changed every 3 days of use. However, please feel free to request a change at any time when necessary.

### Gratuity / Tips

Throughout your stay, our dedicated staff and crew are fully committed to ensuring you have a fantastic Solitude experience, and while gratuities are not expected, they are sincerely appreciated. They recognise the collective teamwork, even from those working behind the scenes, and distribute all tips equally. Should you wish to show your appreciation, a recommended gratuity of 5% to 10% of the total stay cost is suggested. Of course, if you wish to express your appreciation with a higher amount, you are more than welcome to do so.



# The Cabins Floor Plan

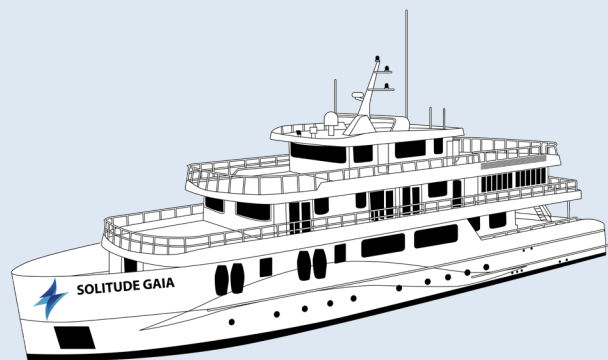

**BELOW DECK INTERIOR CABINS LAYOUT**

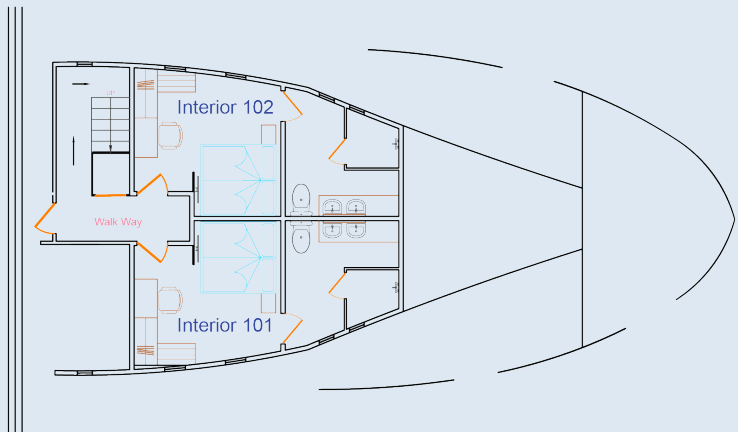

Interior Cabins 101 & 102 - Twin/Double Share

**STATEROOM & UPPER DECK CABIN LAYOUT**

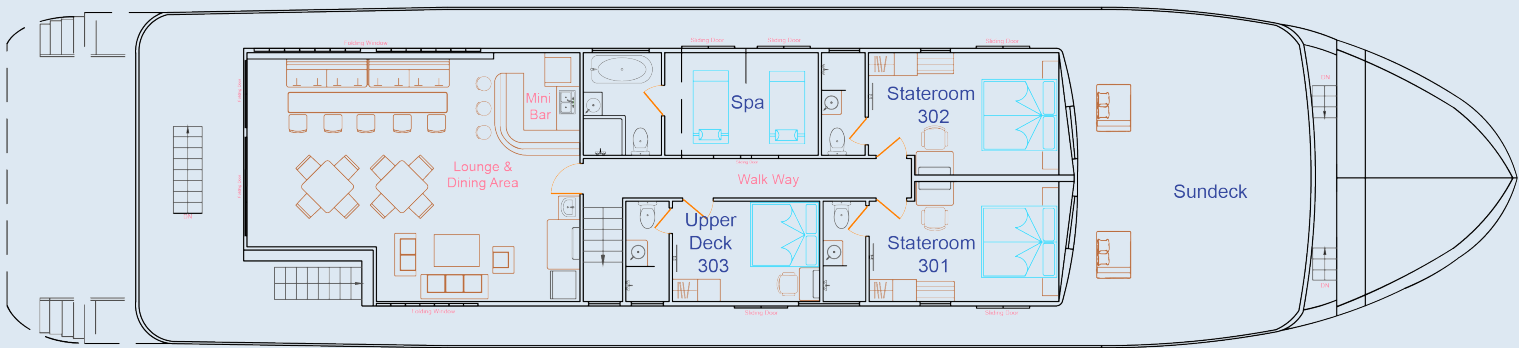

Stateroom 301 & 302 - Twin/Double Share  
Upper Deck 303 - Double Share

**MAIN DECK CABIN LAYOUT**

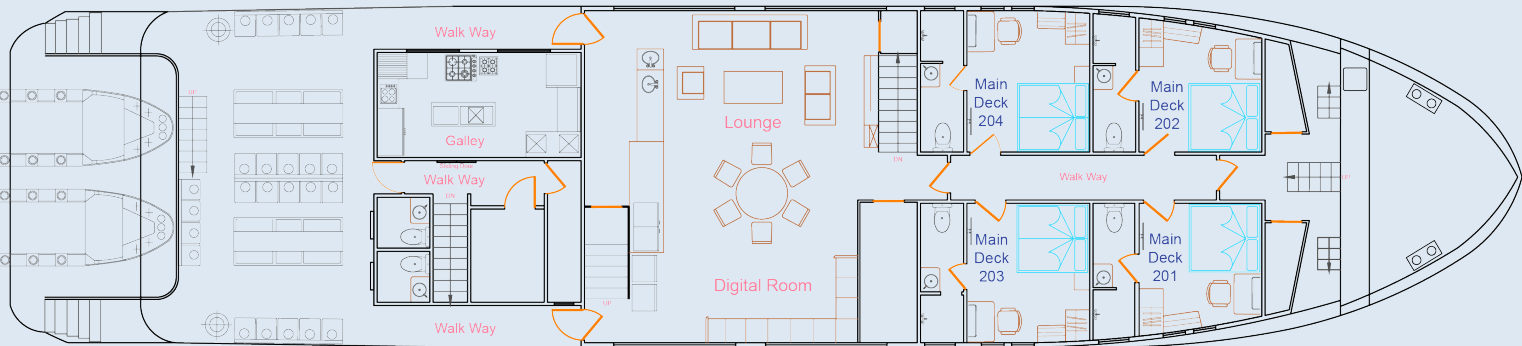

Main Deck Cabins 201 & 202 - Double Share  
Main Deck Cabins 203 & 204 - Twin/Double Share

**NAVIGATION DECK**

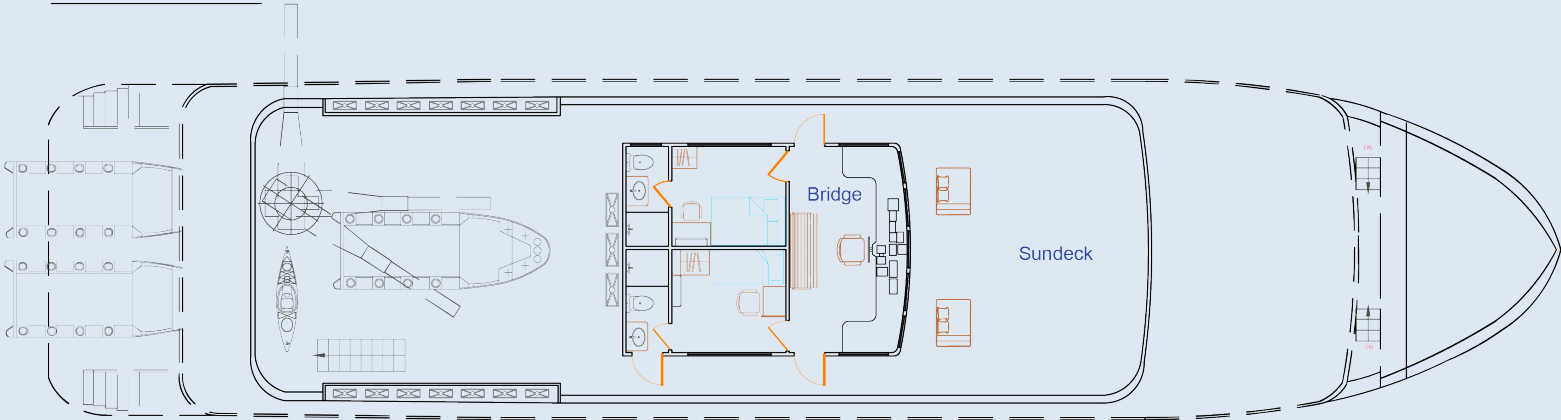





# THE DIGITAL AREA

Our digital area can cater for all your electronic needs.

The ocean provides an idyllic haven for photographers, offering boundless opportunities to capture rare and unique marine life.

Located on the main deck, our digital room is designed to cater to your needs with features such as air conditioning, moisture filters, and spacious powered workstations equipped with universal power points (110 V), ensuring utmost convenience.

Moreover, we provide on-deck facilities including freshwater rinse basins, air guns, and towels, allowing you to easily clean and dry your equipment.

To further assist with camera maintenance, we offer a large camera rinsing tank, consisting of two extra-large tanks exclusively designed for cameras. In addition, towels are readily available for your convenience. For efficient drying, we provide pressurised air as an option.

On the dive deck, you'll find a dedicated camera setup bench where you can prepare your equipment. Additionally, we have a

digital/camera studio equipped with two PC desktop stations exclusively for guest use. Universal power sockets are conveniently available in both guest cabins and the digital/camera studio, operating on a power type of 200V-220V/50Hz.

To ensure the safety of your equipment, surge protection and UPS sockets are exclusively provided in the digital room.

## **Social Media**

We encourage you to share your encounters with the fascinating new critters you'll undoubtedly encounter, as well as your enjoyable experiences with us. Feel free to tag us on social media platforms:

### **Instagram:**

[@Solitude.Gaia](#)

[@solitude.world](#)

### **Facebook:**

[@Solitude.Gaia](#)

[@solitudeliveaboardsandresorts](#)



# PALAU

## The Land of Rainbows

Palau, a tropical paradise nestled in the western Pacific Ocean, is a diver's dream come true. Renowned for its breathtaking natural beauty, this archipelago of over 500 islands offers an unparalleled diving experience that is sure to leave every adventurer in awe.

With crystal-clear turquoise waters teeming with vibrant marine life and an abundance of thriving coral reefs, Palau boasts some of the most diverse and pristine diving sites in the world. From towering limestone islands and dramatic drop-offs to intricate underwater caves and World War II wrecks, the underwater landscape of Palau is a true wonder to explore.

Divers can embark on thrilling encounters with majestic manta rays, graceful sea turtles, and colourful reef fish. Palau is also famous for its thrilling shark encounters, where divers can witness the mesmerising sight of dozens of sharks gliding effortlessly through the deep

blue.

One of the most iconic dive sites in Palau is the world-famous Blue Corner, where strong currents attract an impressive array of marine species. Other must-visit sites include the Blue Holes, Ngemelis Wall, and the German Channel, known for its encounters with graceful manta rays.

Beyond the remarkable underwater world, Palau offers a plethora of topside attractions. Visitors can explore lush jungles, hidden waterfalls, and ancient rock islands. Cultural encounters with the indigenous Palauan people provide a fascinating glimpse into their rich heritage and traditions.

With its pristine diving conditions, diverse marine life, and natural wonders both above and below the water, Palau is a true haven for adventurous divers seeking an unforgettable journey into the depths of paradise.

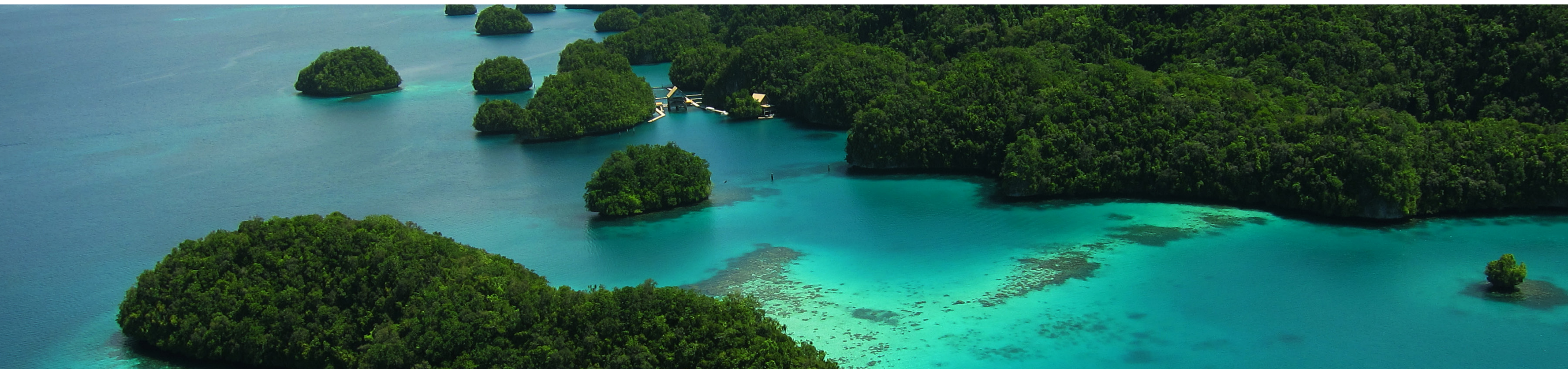

Malakal Marine Park





## Contact Us

[emailus@solitude-liveaboards.com](mailto:emailus@solitude-liveaboards.com)



## Climate

Palau is the 'Land of Rainbows' with a tropical Climate with an annual mean temperature of 27°C (82°F). Rain is frequent between the months of June to October. Periodic rain flashes do occur.



## Water Temperature

Ocean temperatures in the Palau range from 26°C to 29°C (81°F - 84°F).



## Time Zone

Time Zone: GMT +9



## Language

The official language is **Palauan and English** in the Palau.

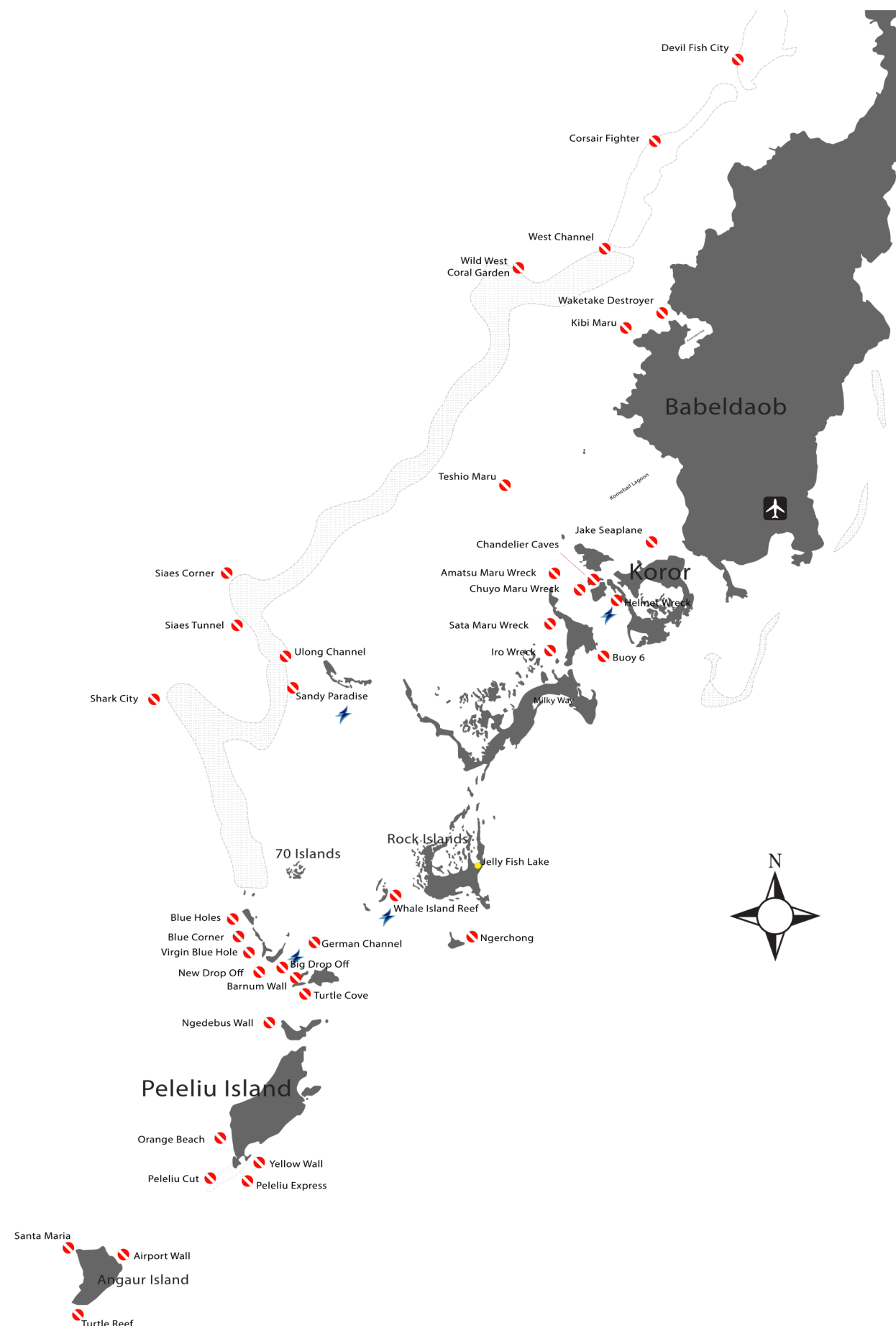

**Dive sites of Palau**



## Currency

The currency is USD. Credit cards are widely accepted in Palau (except AMEX and Diners). Solitude Gaia accepts Visa and Master cards only, a facility fee will be applied. Please inform us at least one night before disembarkation.



## Wifi

Our guests may pre-purchase data packages and log in via our WIFI Network Hotspot on board.

Available Data Packages: USD15/500Mb, USD25/1000Mb, USD35/Unlimited.



## Electricity

On board, Solitude Gaia uses universal sockets compatible with EU, USA, AUS, UK, CN, etc. On land, the electrical system on land is identical to that of the USA, (single phase 60 cycles, 115/230 volts AC).



## Duty Free

Maximum of 1 liter of any type of alcohol, 20 sticks of cigarettes, or 170g (6 ounces) of tobacco. However, fresh or thawed food, including fruits, meat, vegetables, or seafood, is strictly prohibited. If such items are found in your possession upon entry, you may be charged a fee for their disposal.





# **Solitude Gaia** **ITINERARIES**







# Classic Palau 8 Days 7 Nights

## Day 1, Embarkation

Gives the opportunity of a possible 2 to 3 dives.

Choice of sites: Iro Wreck, Chandelier Caves, Jake Seaplane, Hafa Dai Wreck

Boarding for Solitude Gaia begins promptly at 7:00 am and concludes no later than 9:00 am. Upon arrival, our crew warmly welcomes you aboard. Orientation and registration will promptly follow this welcome. Latecomers for boarding are accommodated but must understand that any missed meals, tours, or dives cannot be refunded or exchanged.

Our services include complimentary airport and local hotel transfers. As you step onto Solitude One, our team eagerly awaits to greet you. The registration process, including the collection of Permits and National Parks fees, will commence alongside a reminder to bring your C-Cards and/or Log Books. For a

comprehensive guide on fees and guidelines, refer to our Know-Before-You-Go document. Both Lunch and Dinner are included in your package.

Today signifies the onset of our diving escapades, with Solitude Gaia stationed in Malakal Bay, adjacent to the main town's shoreline. This area bears historical weight, having been a significant battleground during World War II between the US and Japanese armed forces. Near the bustling town of Koror lie numerous shipwrecks from that era, inviting exploration of both submerged vessels and an airplane wreck. Notably, the nearby Chandelier Caves offer a popular and easily accessible cavern dive, presenting a beginner-friendly journey through four distinct air chambers within a spacious cavern adorned with stunning stalactites hanging from the limestone ceiling.

This day unveils a different dimension of Pa-



lau's diving scene, spotlighting the nation's diverse dive sites and rich historical backdrop. While the visibility here may differ from the pristine clarity typically expected in Palau, it adds an enigmatic allure to underwater exploration. Later in the day, we'll embark on a 1-2 hour journey towards Ulong Island, ushering in a new array of diving prospects.

#### **Day 2 & 3 Ulong Island Area**

Gives the opportunity of a possible 3 to 4 dives each day.

Choice of sites: Sandy Paradise / Ulong Channel / Siaes Corner / Siaes Tunnel / Shark City

Leave Malakal Lagoon Anchorage for Ulong Island.

Today, we arise to the sight of Ulong Island's captivating beauty as we anchor nearby. This island features a picturesque, extensive white sand beach and preserves ancient rock art paintings. Renowned for its numerous acclaimed dive sites, this area offers an opportunity to explore various underwater landscapes, including channels, walls, current-rich corners, and breathtaking reefs.

If our schedule and the weather align favourably, there's a chance for a beach outing and the potential for a BBQ on one of the days.

#### **Day 4 - 6 Pelepiu & Ngemelis Island Area**

Gives the opportunity of a possible 3 to 4 dives.

Choice of Sites: Peleliu Cut / Yellow Wall / Peleliu Express / Orange Beach / German Channel / Blue Corner / Blue Holes / New Drop-off / Turtle Cove and more.

Over the upcoming days, our focus shifts to diving in the southern region of the Rock Island Southern Lagoon (RISL) and the outer reefs of Palau. Here, you'll relish in stunning

dramatic drop-offs, thriving coral gardens, robust currents, diverse marine life, and perhaps even the sighting of Manta Rays. Additionally, within this time frame, there will be an opportunity to partake in a World War II land tour of Peleliu Island.

#### **Day 7 Ngemelis Island Area**

Gives the opportunity of a possible up to 2 dives.

Choice of Sites: German Channel / Ngedebus Wall / Dexter's Wall / Ngemelis Coral Garden / Virgin Blue Hole

On this final day of our diving expedition, we'll partake in two morning dives within the central area of Ngemelis Island. Subsequent to these dives, lunch will be served while we sail back to Malakal. During the afternoon, there's an option for complimentary tours via speedboat to Jellyfish Lake, Milky Way, or both. It's important to note that a Jellyfish Lake permit is required if you choose to visit.

At this juncture, you'll receive a briefing concerning your check-out bills for payment arrangement. We accept USD cash (preferred) or credit card. Please notify the cruise directors of your preferred payment method a day before disembarkation. Disembarkation (check-out) is slated for 17:00 (dinner not included). Nonetheless, if space is available, a late check-out until the following day at 23:59 can be arranged, subject to availability and an additional fee. Feel free to inquire about the current rate, which will also cover dinner.

#### **Day 8, Disembarkation**

No Dive Day

Passengers are scheduled for disembarkation between 5:00 am and 7:00 am. Following a light breakfast, farewells will be exchanged, and our crew will facilitate your transportation to the airport. Should guests prefer an earlier disembarkation, they must acknowledge

that missed meals, tours, or dives due to this change are non-refundable and non-exchangeable. We look forward to welcoming you back in the near future!

**Please be aware** that the itinerary and planned route may be altered due to unfavourable weather conditions, sea conditions, and, or restrictions imposed by local authorities.



**Dive Site: German Channel**





Bumphead Parrot  
Fish Spawning,  
William Tan

# Palau New / Full Moon Spawning

## **In sync with our Classic Palau Itinerary,**

Solitude Gaia Palau introduces an alluring expedition through its specialised New/Full Moon Spawning Itinerary, spanning 7 nights and 8 days. This curated journey is crafted to immerse you in the captivating natural spectacle of spawning events. These enthralling occurrences grant a close-up view of fish behaviour, unveiling the intricate rhythms within marine life.

While our itinerary endeavours to coincide with these distinctive events, it's important to note that the species witnessed during spawning, such as the magnificent Bumphead parrotfish, vibrant red snapper, graceful Moorish idol, and others, may exhibit varia-

tion. Their presence hinges on various elements like seasonal changes, specific locations, and the ever-shifting ocean currents. Given the orchestration of these remarkable phenomena by nature, precise timing and occurrences cannot be assured.

Hence, our route and schedule are adaptable, allowing us to flexibly respond to the patterns and manifestations of these spawning events. Join us for an extraordinary venture into the depths, where nature's enigmatic wonders lead our path, ensuring an unforgettable encounter with the fascinating marine life amidst these mesmerising events.



# Palau

## 11 Days 10 Nights

### Day 1, Embarkation

Upon boarding Solitude Gaia, a welcome from the rest of our crew awaits you. Orientation and registration will begin once you are welcomed.

### Day 2

Gives the opportunity of a possible 2 to 3 dives.

Choice of Sites: Helmet Wreck, Chandelier Caves, Jake Seaplane, Teshio Maru

Today marks the start of your diving adventure and your first dive. Solitude Gaia will remain anchored in Malakal Bay, just off the shore of the main town. This area holds significant historical importance as it served as the focal point of a major battle between the US and Japanese armed forces during World War II. Within close proximity to the bustling town of Koror, you will discover numerous shipwrecks from that era, providing the opportunity to explore both sunken vessels and an airplane wreck. Additionally, a popular and easily accessible cavern dive awaits you in the nearby Chandelier Caves, nestled within a rock island. This beginner-friendly cavern/cave dive showcases four distinct air chambers within a spacious cavern, where guests can ascend into these ample air chambers and marvel at the remarkable stalactites that adorn the limestone cave's ceiling.

Today, you will embark on a unique Palau div-

ing experience, immersing yourself in the rich history and diverse array of dive sites within this small island nation. While the visibility in this area may not be as crystal-clear as one might expect from Palau's renowned blue waters, it adds an air of mystery to the overall experience. We will remain anchored here overnight, allowing you to fully embrace the allure of this captivating location.

### Day 3

Gives the opportunity of a possible 4 dives.

Choice of Sites: Iro Wreck, Helmet Wreck, Chandelier Caves, Buoy 6

Leave Malakal Lagoon Anchorage for Ulong Island after first dive.

As the sun rises, we find ourselves amidst the breathtaking limestone rock islands of Malakal Harbour. Today presents us with more opportunities to dive and discover the hidden gems within the inner lagoon. In the afternoon, we set sail towards the enchanting Ulong Island.

### Day 4

Gives the opportunity of a possible 4 dives.

Choice of Sites: Siaes Tunnel, Siaes Corner/Ulong Channel, Sandy Paradise

Moored just off the stunning white sand beach of Ulong Island, we awaken to a day filled with incredible diving opportunities. The



Ulong area beckons with its mesmerizing walls, vibrant reefs, and dynamic currents. Drifting along these vertical walls gives you a sensation of soaring, as you marvel at the flourishing coral and abundant marine life. Schools of colourful reef fish gracefully ride the currents, while the corners teem with sharks, creating an exhilarating experience for those hooked on adventure. The pristine white sand and crystal-clear waters in this paradise-like setting accentuate the allure of the reef walls that plunge into the depths. Our stay in this captivating area extends into the night, immersing us in the true essence of Ulong Island.

### Day 5

Gives the opportunity of a possible 3 to 4 dives.

Choice of Sites: Siaes Tunnel /Siaes Corner, Ulong Channel, Sandy Paradise

Leave Ulong Island Anchorage for Whole Island.

As the sun rises, we find ourselves still in front of Ulong Island, ready to embark on another exciting dive in this area before heading further south. The exceptional visibility in these waters often captivates divers with its breathtaking wide-angle views of vibrant reefs and towering walls. However, if you pay closer attention to the reef itself, you'll discover that Palau is also home to an impressive variety of macro marine life.

In the afternoon, our journey takes us through the remarkable German Channel, a shallow passage carved through the reef during the German occupation to facilitate navigation between Palau's islands. Surrounding most of the country is a barrier reef, with the southern half encompassing the prestigious UNESCO



World Heritage site known as the Rock Island Southern Lagoon (RISL). Due to the shallowness of the reef, larger ships must navigate the longer route along the outer edge of the barrier reef to reach the southern islands. Fortunately, our skiffs can traverse the German Channel, offering us a shorter and more convenient route to the southern dive sites.

The actual dive site of the German Channel is located south of the boat passage, where the channel's southern edge gradually slopes into the deep waters. It is in this area that Manta Rays gather to feed and seek cleaning stations, providing a mesmerising spectacle for divers. As we venture further south, we arrive at the southern outer reef, where some of Palau's most renowned dive sites eagerly await our exploration. While we delve into the underwater wonders during the day, Solitude Gaia will embark on a lengthy journey via the eastern outer reef, circumnavigating the southern tip of Peleliu to reunite with us.

#### **Day 6 to 9**

Gives the opportunity of a possible 4 dives per day.

Choice of Sites: Peleliu Cut, Peleliu Express, Orange Beach/ German Channel, Blue Corner /Blue Holes / Turtle Cove, Big Drop Off/New Drop Off, Ngedebus Wall

We spend the next 4 days diving the current swept walls and corners of Ngemelis island, home of the Blue Corner and Blue Holes, Peleliu and Carp island. Clear water, stunning coral gardens, and massive schools of both big and small fish, including an impressive number of sharks await. You'll have plenty of chances to navigate current and learn how to utilise a reef hook properly. During these days there is the potential for an optional Peleliu island WW2 land tour, dependent on guest interest and weather conditions (a dive must be skipped to fit the land tour into the daily schedule).

#### **Day 10**

Gives the opportunity of a possible 3 dives. Your last dive has to conform to our 18 hours no-fly/no-altitude policy.

Choice of Sites: German Channel, Blue Corner, New Drop Off, Big Drop Off /Ngedebus Wall



As we reach our final day of diving, you have become a skilled diver adept at utilising the reef hook and mastering the currents of Palau. We will embark on our last dives, bidding farewell to the enchanting southern reefs of this remarkable destination. With each dive, we savour the underwater wonders one last time before we leisurely sail back to Malakal Harbour, cherishing the memories created during our unforgettable journey.

Return to Malakal Lagoon Anchorage in the late evening

#### **Day 11, Disembarkation**

No Dive Day

Passengers are scheduled for disembarkation between 5:00 am and 7:00 am. Following a light breakfast, farewells will be exchanged, and our crew will facilitate your transportation to the airport. Should guests prefer an earlier disembarkation, they must acknowledge that missed meals, tours, or dives due to this change are non-refundable and non-exchangeable. We look forward to welcoming you back in the near future!

**Please be aware** that the itinerary and planned route may be altered due to unfavourable weather conditions, sea conditions, and, or restrictions imposed by local authorities.



# SOLITUDE WORLD

Liveaboard or Resort, we serve as your gateway to the Coral Triangle.

Solitude World is the ultimate destination for adventurers seeking to explore the pristine waters of the Coral Sea while enjoying the comforts of relaxed luxury.

We offer an extensive range of experiences, from encountering nudibranchs and unique critters to exploring bluewater reefs and big pelagics. Our three liveaboards, Solitude Adventurer, Solitude One and Solitude Gaia, are carefully scheduled to coincide with the prime diving seasons in Raja Ampat, Banda Sea, Forgotten Island, Komodo, as well as in the Philippines and Palau.

Solitude Lembeh Resort, is renowned as one of the critter capitals of the world, providing you with ample opportunity to explore from the black sand to the blue water, and even up to the local highlands.

We also offer Solitude Acacia Resort, located in the Philippines, which is the perfect destination for more macro critters especially nudibranchs and blackwater diving.

With Solitude World, you can rest assured that you will witness some of the world's most impressive marine creatures, and dive in the world's most abundant waters while experiencing the Solitude World's service and comforts.

## Liveaboards

### Solitude Adventurer Indonesia

Embark on an extraordinary voyage of exploration and immersion into the untamed beauty of the Indonesian islands with the Solitude Adventurer. This remarkable catamaran, a masterpiece conceived and custom-built by Austal in Australia, invites you to discover the raw nature that thrives both above and below the waterline. Originally launched as a family yacht to commemorate the new millennium for a prominent Singaporean family, the Solitude Adventurer has undergone meticulous transformations to offer unparalleled hospitality and diving experiences.

Step aboard and be captivated by the sheer magnificence of this 36m (118ft) long and 12m (39ft) wide vessel. Bathed in natural light and featuring an abundance of space, the Solitude Adventurer ensures your utmost comfort as you embark on unforgettable cruises to Indonesia's most awe-inspiring destinations. Prepare to be enchanted by the untouched splendour of Komodo, the Forgotten Islands, Raja Ampat, and beyond.

Above the waterline, towering cliffs stand majestically, framing the rugged landscapes that beck-

on exploration. From breathtaking viewpoints, gaze upon the awe-inspiring vistas that unfold before your eyes, only witnessed by a fortunate few. Below the waterline lies a world of wonder, where vibrant coral reefs teem with an astounding array of marine life. Dive into crystal-clear waters and encounter the captivating beauty that resides beneath the surface.

The Solitude Adventurer has been meticulously outfitted to cater to your every need and desire. Each detail has been carefully considered, ensuring your journey is one of utmost comfort and indulgence. Immerse yourself in luxurious amenities, relish delectable cuisine served in elegant surroundings, and unwind in spacious accommodations that blend modern elegance with a sense of tranquility.

As you set sail on this extraordinary vessel, you embark on a voyage that transcends the ordinary. Discover the remote paradises of the Indonesian islands, where nature's wonders unfold in their purest form. Prepare to be enchanted, as the Solitude Adventurer invites you to experience a realm of untouched splendour and create memories that will last a lifetime.





## Solitude One

### Palau and The Philippines

Embark on an unforgettable adventure with Solitude One, exploring the blue wonder of Palau and The Philippines, a must-visit destination for divers and ocean lovers alike. Dive into the crystal-clear waters teeming with vibrant marine life, magnificent coral reefs, and awe-inspiring underwater landscapes. Immerse yourself in the rich biodiversity and captivating beauty of these pristine destinations, creating memories that will last a lifetime. Prepare to be amazed as you discover the hidden treasures and experience the unparalleled magic of these remarkable underwater realms.

Originally a merchant's vessel, the MV Solitude One has been rebuilt to set new standards in hospitality and professionalism. Equipped with the latest onboard technology, it ensures the comfort and safety of all guests throughout their journey. In fact, it embarked on a remarkable charter for a cross-border expedition to Woleai Atoll in the mid-

dle of the Pacific, partnering with NASA and the Exploratorium for the Total Solar Eclipse in 2016.

The dive deck, conceptualised and designed by experienced dive professionals, offers everything you need for a fantastic dive within arm's reach. With ample space to accommodate up to 24 divers, it provides storage for scuba equipment, accessories, video and photo gear, rinse tanks, and even features six freshwater showers. Your needs are carefully attended to, both before and after your dive.

This extraordinary vessel marries extravagant design and layout with the functionality and comforts that are reminiscent of home. The MV Solitude One promises an unparalleled experience for its valued guests, ensuring they feel at ease throughout their journey.



## Resorts

### Solitude Acacia

#### Anilao, The Philippines

Solitude Acacia, located in Anilao, The Philippines, has undergone a remarkable transformation. Formerly known as 'Acacia Resort and Dive Centre,' it partnered with Meseta Corp in 2018 to bring a fresh and contemporary design, elevating the resort to new levels of quality and professionalism under Solitude World's management. Our commitment is to provide an exceptional experience for our guests.

Immerse yourself in a breathtaking dining experience at our botanical restaurant, situated on the second level with 180° glass walls that offer panoramic views of the ocean and pool. Our modern and stylish restaurant provides the perfect setting to savour a variety of local and international cuisine. Whether you choose the air-conditioned glass-walled area or the al fresco dining option, you'll be surrounded by the beauty of our resort.

Our fully equipped dive centre is designed to cater to divers of all levels, including beginners. With a contemporary and functional design, we offer courses and training in our spacious classroom that can accommodate up to 12 students. Additionally, our resort's swimming pool provides a convenient and safe environment for dive training.

Solitude Acacia Resort welcomes guests with 25 spacious and well-appointed rooms, featuring a fresh new contemporary design. Each room is thoughtfully crafted to blend modern aesthetics with the natural surroundings, ensuring a comfortable and stylish retreat amidst the tropical gardens.



## Solitude Lembeh Resort

### Lembeh Strait, Indonesia

Located on just over half a hectare in North Sulawesi, Indonesia, Solitude Lembeh Resort is a remarkable retreat that boasts a rich history of cherished friendships and enduring values. The resort's distinctive blend of cultures and fascinating past make it a truly one-of-a-kind destination. Guests can choose from two Seafront Villas, eight Garden Villas, and eight Deluxe Rooms, all designed to provide an authentic and comfortable experience. With a combination of traditional Indonesian architecture and modern amenities, each villa offers a cozy ambience where guests can easily unwind and relax. The resort's main goal is to create a peaceful and restorative haven for guests, giving them a chance to recharge and unwind. The Solitude team is dedicated to making every moment of guests' stay memorable, ensuring they leave with unforgettable and revitalising experiences.

Lembah Strait, one of the most famous dive destinations in the world, is an absolute must for divers venturing to Indonesia.

Lembah has become world renowned for its plethora and diversity of critters with many found only in the local area such as the Hairy Octopus or Lembah Sea Dragon.

Divers can expect mild currents, low surge and shallow sites, making the area suitable for divers of all experience levels from a beginner to the veteran photographer. The water temperature varies depending on the time of the year, with the lowest being in July and August when the temperature drops to around 25°-26° degrees Celsius or 79°- 81° Fahrenheit. Please refer to page 8 for our Water Temperature Guide. To ensure your comfort we recommend that you bring a 3mm with a vest or a 5mm wetsuit, especially if you are planning on doing several long dives a day. We have additional layers for rent if you find you need more warmth.

Our primary focus is on macro and critters, so visibility is not typically a major concern for us. Nevertheless, it is worth noting that we occasionally encounter excellent visibility of up to 40 meters on the East of Lembah, while inside the strait, the average visibility is around 10 meters.



CONTACT FORM

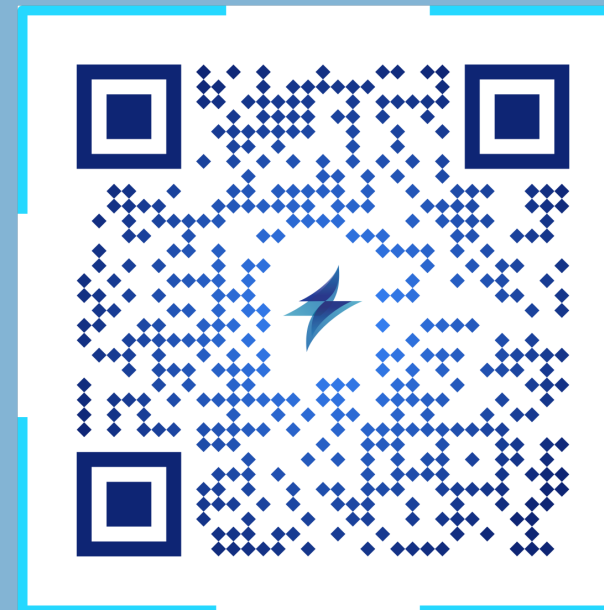

## CONNECT WITH US

Our team is thrilled and prepared to assist you in planning your next adventure with us. Keep in touch by scanning the QR code and let the journey unfold.

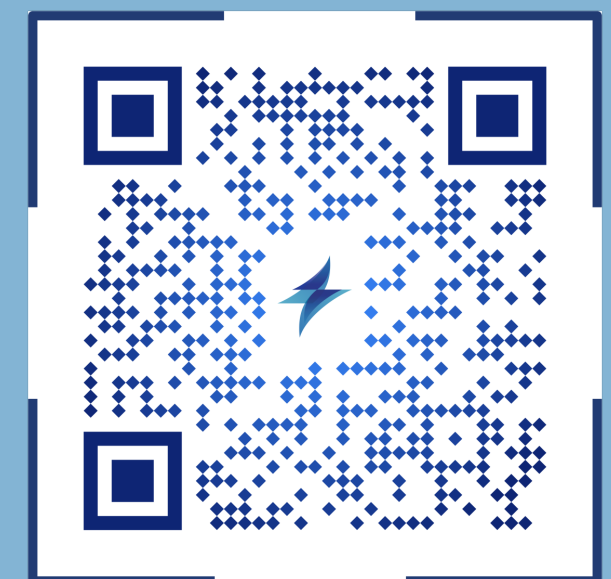

EMAIL US



# RETURNING GUEST PRIVILEGES

## RESORTS Solitude Lembah & Solitude Acacia

Enjoy PHP 1,500 or IDR 450,000 credit per person.

Valid only for credit at the in-house bar and restaurant; for in-service laundry, equipment rental and EANitrox upgrade.

## LIVEABOARDS Solitude Adventurer, Solitude Gaia & Solitude One

Enjoy USD 50 onboard credit per person.

Valid only for credit at the onboard bar and boutique; for in-service laundry, VSAT internet, equipment rental and EANitrox upgrade.

Complimentary Cabin Upgrade on check-in if available.

### Conditions for Credits:

- Applicable only to Solitude World diving or non-diving packages
- Verification is required. We can verify the previous bookings ourselves. However, under some circumstances we may ask you for proof of previous booking.
- Privileges are not transferable
- Credit cannot be used as means to negotiate additional discounts or benefits
- All privileges are only valid for the stay of package duration
- Credit balanced or any unused privileges cannot be carried forward nor refunded.
- Strictly no exchange or cash permitted
- Solitude reserved the right to rescind these privileges

[www.solitude.world](http://www.solitude.world)



FACEBOOK



INSTAGRAM



Come and join us  
on our social media  
platforms to keep in  
touch, stay informed  
and become part of a  
lively community.



WWW.SOLITUDE.WORLD

[www.solitude.world](http://www.solitude.world)