

262 Solitude  
One

ONE

Guest Information  
Booklet

# CONTENTS

04	MV Solitude One
07	Vessel Facts
08	Safety
9	Safe Diving
12	The Diving Specifications
14	Onboard Hospitality
16	About the Cabins
21	The Digital Room
22	Tubbataha
26	MV Solitude One Itineraries
28	Destination: Tubbataha
32	Solitude World
37	Connect With Us & Keep In Touch
38	3SIXTY Appreciation Program
40	Join Our Community





# MV SOLITUDE ONE

Transformed from a Japanese merchant vessel to redefine quality...

**Solitude One, originally a Japanese merchant vessel, has undergone a transformation to raise the standards of quality service and professionalism in the diving hospitality industry.** The primary focus of Solitude One is the safety and comfort of its clients, and it has been meticulously constructed with intelligent designs, functional features, and a cosy ambience reminiscent of home, all while infusing a delicate sense of thoughtfulness. The well-trained staff onboard cater to every guest, addressing them by name, anticipating their individual needs, and appearing only when necessary, thereby ensuring the privacy and familiarity of a 'home away from home' experience.

Despite its rugged and sturdy exterior, Solitude One is far from ordinary. This floating sanctuary stretches over 52 meters and encompasses four decks, providing a remarkable experience. With a total of 10 ensuite cabins, Solitude One can comfortably accommodate up to 24 guests. The cabins are spread across two floors and include two state rooms, seven deluxe cabins, and one quad share cabin.

Solitude One boasts one of the most spacious dive decks, complete with rinse tanks for diving equipment and cameras, hot and cold showers, and ample racks for all diving paraphernalia. Additionally, the vessel provides Enriched Air Nitrox and equipment rental services. For added convenience, complimentary items such as the Nautilus lifeline (GPS-VHS radio), SMBs, and Reef Hooks are available if needed.

When not engaged in diving activities, guests have the opportunity to relax in the lounge while watching watch movies, play games, or work on photos in the dedicated camera room. The vessel also offers a spacious weather deck for sunbathing and a jacuzzi for a refreshing dip. Furthermore, even after enjoying the five meals provided each day in the form of buffets, guests can indulge in cup noodles, cookies, cakes, candy, and an abundance of tea, coffee, and soda.

Safety is of paramount importance on Solitude One, as the vessel is equipped with state-of-the-art communication, navigation, and safety technology. The crew is well-trained and prepared to execute all emergency and non-emergency procedures, while each skiff is equipped with first aid kits and medical oxygen.



## VESSEL FACTS

Solitude World, a private limited company based in Singapore, is the managing and owning entity behind the remarkable Solitude One, **Solitude's flagship vessel.**

**Type and Year Built** the Steel Mono-Hull, constructed in 2013, has undergone a complete rebuilding process, although its original construction dates back to 1979.

**Port of Registry/Flagged** Cebu, Philippines

**Cruising Itinerary Routes** The Philippines.

**Length** 52m (meters) **Beam** 8.6m **Draft** 5m or **Length** 171ft (feet) **Beam** 28ft **Draft** 16.4ft

**Cruising Speed** 10 Knots, top speed 14 Knots

**Diesel Capacity** 150,000L (39,473 US Gal.)

**Cruising Range** approximately 9000 nautical miles (16,668 km).

**Engine & Propulsion** main engine with 2698HP (2013kW) and auxiliary propulsion engine.

**Electricity** 1 x 250kVa, 2 x 125kVa, and 1 x 15kVa generators providing 24 hours of 200V to 240V - 50Hz power.

**Navigation** equipped with local navigation maps, Furuno GPS chart plotter, radar (long/short range), weather plotter, and depth sounder.

**Communication System** VHF/SB radios, VSAT satellite phone & internet, Inmarsat-C

**Ship Safety System** GMDSS with EPIRB, AIS, life rafts, emergency survival packs, semi-automated fire suppression sprinkler system.

**Fresh Water Capacity** 50,000L (storage) with an on-board water-maker capable of producing 7600L (2000 US gallons) of fresh water per day.

# SAFETY

SAFETY is Solitude's top priority, we take every precaution to ensure the safety of our guests and crew. As we operate in remote areas we ensure that we are well-equipped to handle any emergency scenario.

During your stay onboard we provide our guests with a complimentary Nautilus Marine Rescue GPS to provide that peace of mind when out diving in the remote parts of the Philippines.

Our Features & Global Maritime Distress and Safety System (GMDSS) equipped with:

- Emergency Position-Indicating Radio Beacon (EPIRB)
- Life Rafts
- Emergency Survival Packs
- Semi-Automated Fire Suppression Sprinkler System
- VHF/SB Radios
- VSAT Satellite Phone & Internet
- Inmarsat-C
- Local Navigation Maps with Furuno GPS Chart Plotter
- Radar (Long/Short)
- Weather Plotter
- Depth Sounder
- 50,000L Water Storage with On-board Water-Maker capable of producing 7,600L of fresh water per day.

# SAFE DIVING

We understand that your time and investment in a holiday are valuable, and we aim to provide you with as many dives as possible while ensuring your safety.

To prioritise safety, we require a minimum of 6 hours of rest before your first dive this will ensure that you are well-rested and hydrated before your first dive.

We recognise that although you have learned about safety during your scuba course/s, the excitement and anticipation of a diving holiday can sometimes cause us to neglect our own readiness for a dive.

Our crew's safety is also important, so we limit the number of dives to four per day, including a night dive, to minimise fatigue and reduce the risk of accidents.

Itineraries are subject to change due to weather and logistics, but our cruise directors will keep you informed.

**Dive Site: Jake Seaplane**

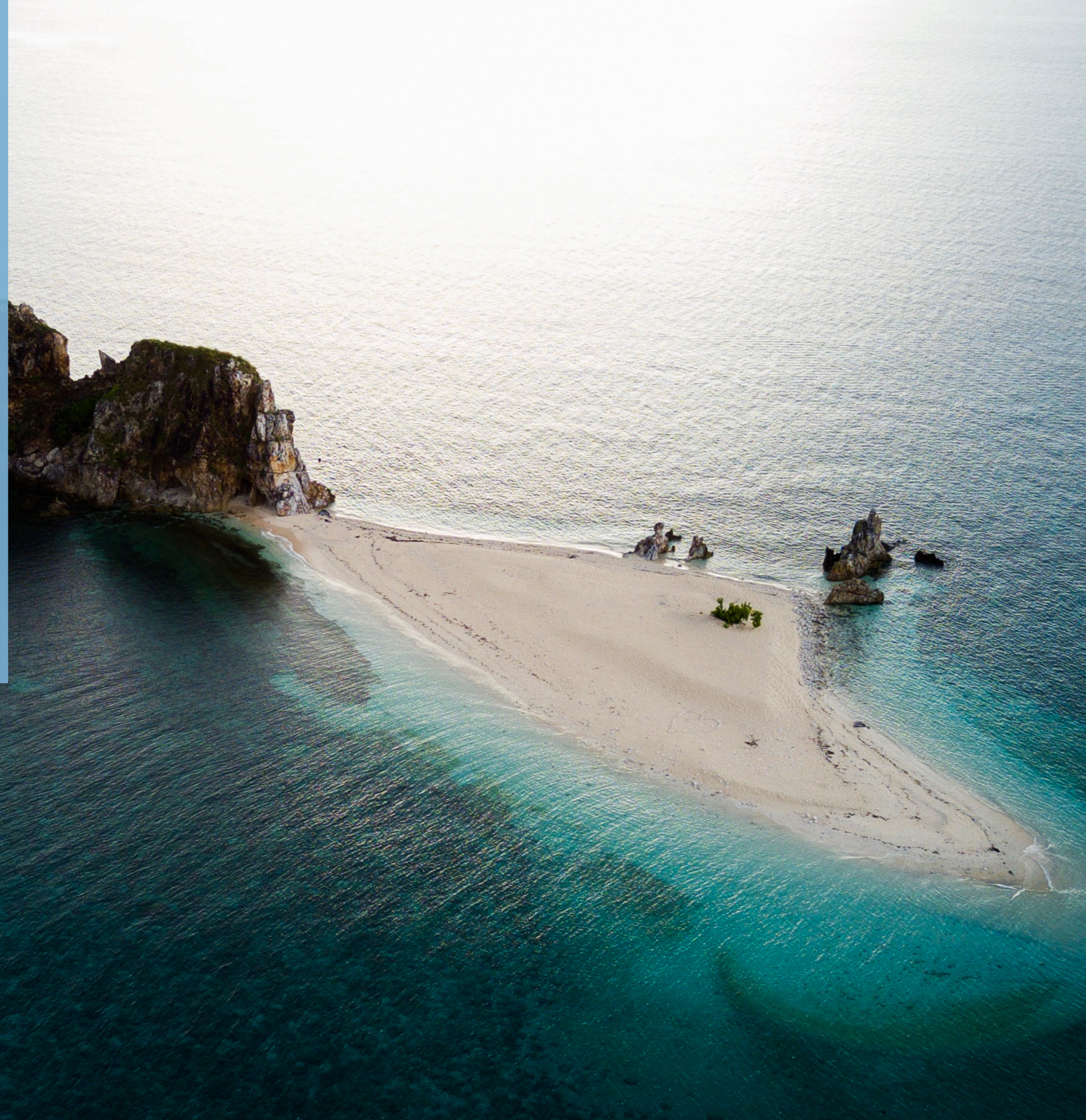

# THE DIVING SPECIFICATIONS

We aim to provide you with as many dives as possible while ensuring your safety.

**Dive Skiffs** there are two purpose-built fibreglass boats measuring 11.5m (37ft) each, equipped with twin 200HP and twin 150HP 4-stroke outboard engines.

**Support Skiff** 1 x 8.3m (27ft) Fibreglass Monohull with single 60HP 4-Stroke Engine.

**Air Compressors** 3 x Bauer HP Compressor IK120 with Bauer B-Kool 680-s Air Cooler Filtered by P41 Centralised System.

**Nitrox Membrane System** LP450 Nitrox Membrane.

**Dive Guides** ratio 1 to 6 divers. Private Guide Service is available for USD150 per diving day (pdd).

**Dive Equipment Rental** is available, which includes dive computers, but underwater cameras are not included. Nautilus Lifeline GPS is complimentary [Nautilus Marine Rescue GPS](#). Please note that if you use the Nautilus Rescue Device, you are responsible for replacing it if lost or damaged.

**Surface Marker Buoy (SMB), Lead Weights & Belt** are complimentary.

**Enriched Air Nitrox Diving** EANx 28 to 32%, to provide a more suitable M.O.D for divers.

## YES%

### Enriched Air Nitrox

Enriched Air Nitrox is exclusively offered to certified divers. Our proficient dive team will determine the blend, approximately between 28-32%, considering the MOD, dive site, its profile, and target species, ensuring the best opportunity for a safe and optimised diving experience.

### Dive Shop

On-board, you can purchase Surface Marker Buoy (OPV, SOLAS Reflector), Nautilus Lifeline GPS/VHF Radio (with Pouch), Spools, Dive Pointers, Drift Hooks, o-rings, Hoses, and other common replaceable spares. We recommend placing an advance order, as quantities are limited.

Prior to diving, it is mandatory to present proof of certification and dive insurance.

**Scuba Cylinders** Aluminium 100cuft (19units), 80cuft (80 units), 63cuft (4 units), 40cuft (12 units) and 19cuft (4 units) with DIN Valves (York Adapters available). Twin tanks are not available, side-mount friendly.

**Rebreather Support** only on full charters with rebreather divers. Organising scrubbers requires advanced notice of 60 days or more, although there is no guarantee. Alternatively, you have the option to order and send them to us.

**Medical Oxygen and Comprehensive First Aid Kits** are available

**NO SOLO diving** is allowed, even if you are certified.

**It is mandatory for all guests** engaging in scuba activities to have an audible signalling device (such as a whistle), a dive computer, a surface marker buoy, appropriate dive insurance coverage, a valid dive certification, and have completed waiver forms A and C for the activities.

### Dive Centre

1	EANitrox prices are as follows: USD8 per dive OR USD135 for 8D/7N and 7D/6N itinerary, with subsequent additional use USD20 per day	Yes
2	100 cu.ft. / 15L cylinders - additional charge USD10 per cylinder per diving day (pcpdd)	Yes*
3	Side mount support - additional 12L/80cu.ft. cylinder available. Air USD10, EANitrox USD28 pcpdd. Whole trip use: 10% discount applies	Yes*
4	DIN valves with option of Yoke (A-clamp)	Yes
5	Rebreather diving costs only USD0.06 per litre* for oxygen filling. Dive profiles must consider other guests' comfort and safety. Helium, if required, may be costly. Full charter profiles are not limited to standard recreational limits.	Yes
6	Rental gear available	Yes*
7	Private Guide Service is available for USD150 pdd.	Yes*

\* Subject to availability/change



## ONBOARD HOSPITALITY

Onboard, we prioritise your comfort and relaxation, encouraging you to unwind and feel at ease throughout your journey.



- Reading Library - with a loan & exchange program.
- Entertainment Lounge - play-on-demand audio and video system with a wide selection of entertainment options, card and board games for your enjoyment.
- Coffee available - fully automatic (self-service) pressed coffee machine, local and instant coffee.
- Tea available - Ceylon, chamomile, green and Chinese.
- Drinking Water - free flow from reverse osmosis water dispenser
- Alcoholic Beverages\* - onboard include a variety of options such as beer, red, white, and rosé wine, as well as popular liquors. We also have a 'Bring Your Own' (BYO) policy in place, and there is no corkage charge for bringing your own alcoholic beverages.
- Non-Alcohol Beverages - popular selections including light and zero options if available locally.
- Self-Serve Snacks - available 24 hours.
- Ice Maker - available.
- Special Dietary Requests - we can accommodate vegetarian and selective non-meat options. Vegans will require advanced notice with a specific list of allowable ingredients for their meal preparation.
- Solitude Souvenirs & Apparel\*- While the development of Solitude One apparel is still ongoing, you have the opportunity to acquire local souvenirs when we visit the nearby shopping mall.
- On-Board Guests Services\* - satellite internet and laundry

\*additional cost

# ABOUT THE CABINS

The cabins are thoughtfully designed, inspired by years of experience and guest feedback, incorporating essential elements.

With meticulous attention to detail, MV Solitude One offers a total of 11 cabins, providing ample accommodation for a maximum of 24 guests. These cabins have been thoughtfully designed, drawing inspiration from years of experience, valuable guest feedback, and incorporating essential elements from the hospitality industry. The aim was to create a space that caters to the discerning needs and desires of divers, while also ensuring a tasteful and practical design.

For our taller guests, they will be pleased to know that our headroom is adequate in most guests' areas and the length of all our mattresses in every cabin category are a minimum 190cm (6.2ft).

## Overview

### Cabins

- Staterooms A1, A2, A3, B6: 2 x King-Sharing, 1 Twin Sharing, 1 x Single/Double-Sharing
- Deluxe Cabins B1, B2, B3, B4, B5, B7: 2 x Double-Sharing and 3 x Twin-Share, Bunk Bed style, 1 x Single/Double Sharing
- Quad Cabin B8 4 x single beds

### Mattress Sizes:

- King Mattresses 180cm x 200cm (Cabins A1 and B6)
- Queen Mattresses 152cm x 190cm (Cabins B1 and B2)
- Full Double 140cm x 190cm (Cabins A3 and B4)
- Twin/Single Mattresses 90cm x 190cm (Cabins A2, B3, B5, B7 and B8)

### Bathroom

Every cabin and stateroom on board is equipped with an en-suite shower (providing both hot and cold water) and a WC featuring a common water-flush system.

### Cabin Comforts

- Individual air conditioning system with climate control
- A safe deposit box, an additional box can be provided if sharing is not suitable
- Bathrobes
- Face and bath towels
- Hair dryer
- Reading lights
- Shower foam, 2 in 1 Shampoo Conditioner



- Bedding including pillows, duvet, sheets. Extra pillows and light blankets are available on request
- Wardrobe organiser with ample hangers
- Universal electrical points conveniently located for gadgets

### Ensuite Shower and Toilet

The cabin en-suite showers and toilets are thoughtfully designed to cater to the needs of modern-day users. While the size may vary depending on the cabin category, even the most compact cabins provide sufficient room, shelving, and space to accommodate your personal toiletries. All en-suite facilities are equipped with the following amenities:

- Hot & cold water manual bidet gun
- Seated water closet (WC)
- Separate shower
- Ample space for hanging

### Housekeeping Practice

Cabins are cleaned daily. Sheets, bath and face towels are changed every 3 days of use. However, please feel free to request a change at any time when necessary.

### Gratuity / Tips

Throughout your stay, our dedicated staff and crew are fully committed to ensuring you have a fantastic Solitude experience, and while gratuities are not expected, they are sincerely appreciated. They recognise the collective teamwork, even from those working behind the scenes, and distribute all tips equally. Should you wish to show your appreciation, a recommended gratuity of 5% to 10% of the total stay cost is suggested. Of course, if you wish to express your appreciation with a higher amount, you are more than welcome to do so.

# The Cabins Floorplan

## A DECK / Main Deck

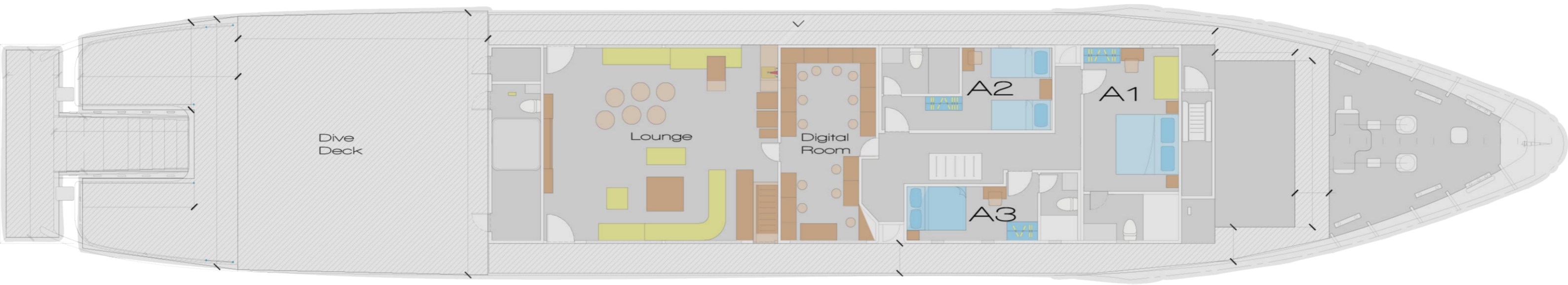

## B DECK / Below Deck





# THE DIGITAL ROOM

Our digital room can cater for all your electronic needs.

The ocean provides an idyllic haven for photographers, offering boundless opportunities to capture rare and unique marine life.

Located on the main deck, our digital room is designed to cater to your needs with features such as air conditioning, moisture filters, and spacious powered workstations equipped with universal powerpoints (110 V), ensuring utmost convenience.

Moreover, we provide on-deck facilities including freshwater rinse basins, air guns and towels, allowing you to easily clean and dry your equipment.

To further assist with camera maintenance, we offer a large camera rinsing tank, consisting of two extra-large tanks exclusively designed for cameras. In addition, towels are readily available for your convenience. For efficient drying, we provide pressurised air as an option.

On the dive deck, you'll find a dedicated camera setup bench where you can prepare your equipment. Additionally, we have a digital/

camera studio equipped with two PC desktop stations exclusively for guest use. Universal power sockets are conveniently available in both guest cabins and the digital/camera studio, operating on a power type of 200V-220V/50Hz.

To ensure the safety of your equipment, exclusive surge-protected UPS sockets for sensitive devices.

#### **Social Media**

We encourage you to share your encounters with the fascinating new critters you'll undoubtedly encounter, as well as your enjoyable experiences with us. Feel free to tag us on social media platforms:

#### **Instagram:**

[@mvsolitudeone](#)

[@solitude.world](#)

#### **Facebook:**

[@MVSolitudeOne](#)

[@solitudeliveboardsandresorts](#)



# TUBBATAHA

Brace yourself with awe inspiring encounters with a vibrant tapestry of corals and marine creatures from macro to huge pelagics.

Experience a scuba diving adventure like no other as you explore Tubbataha Reefs Natural Park with Solitude Liveboards. This remarkable UNESCO World Heritage Site and ASEAN Heritage Park encompass a protected marine area spanning 130,028 hectares in the middle of the Sulu Sea, located in the Palawan region of the Philippines. Join us on the majestic Solitude One as we journey 150 kilometres away from the Port of Puerto Princesa, immersing ourselves in the breathtaking beauty of clear blue waters teeming with abundant marine life.

Let our team of experienced local dive guides lead you through the stunning dive sites of Tubbataha. With magnificent walls and drop-offs, such as Delsan Wreck, Washing Machine, Shark Airport, and the renowned Jessie Beazley Reef, you'll encounter a vibrant tapestry of colourful marine creatures. Brace yourself for awe-

inspiring encounters with sea turtles, barracudas, jacks, reef sharks, and the opportunity to spot magnificent pelagic species like whale sharks, manta rays, the endangered bumphead wrasse, and even playful dolphins if luck is on your side. With exceptional visibility exceeding 40 meters and remarkably healthy reef systems, each dive will treat you to an abundance of mesmerising reef fish.

Tubbataha's regular dive season lasts only three months each year, from mid-March to mid-June. Don't miss out on the chance to discover the mesmerising beauty of this extraordinary dive destination with Solitude Liveboards.



## Contact Us

address: MV Solitude One

phone: +63 956 826 0839

[emailus@solitude-liveaboards.com](mailto:emailus@solitude-liveaboards.com)



## Climate

Tropical Climate with an annual mean temperature of 27°C (82°F). Rain is frequent between the months of June to October. Periodic rain flashes do occur.



## Water Temperature

Ocean temperatures in the Philippines range from 26°C to 29°C (81°F - 84°F).



## Time Zone

Time Zone: GMT +8



## Language

The official language is **Tagalog** in the Philippines, but English is also the working language of the country.



**Tubbataha, The Philippines**



## Currency

The currency is Philippine Peso (PHP) or United States Dollar (USD). Credit cards are widely accepted in the Philippines. Solitude One accepts Visa and Master cards only, a facility fee will be applied. Please inform us at least one night before disembarkation.



## Wifi

Our guests may pre-purchase data packages and log in via our WIFI Network Hotspot on board.

Available Data Packages: USD15/500Mb, USD25/1000Mb, USD35/Unlimited.



## Electricity

On board, Solitude One uses universal sockets compatible with EU, USA, AUS, UK, CN, etc. On land, the electrical system on land is identical to that of the USA, (single phase 60 cycles, 115/230 volts AC).



## Duty Free

1 Adult is allowed: 2 bottles, maximum 1 litre each of alcohol and no more than 400 sticks of cigarettes, 50 cigars or 250g (8.8 ounces) of tobacco.



# MV SOLITUDE ONE ITINERARIES

# Tubbataha 7 Days 6 Nights

## Day 1, Embarkation at Puerto Princesa

Check-in for the cruise begins at 1400Hrs at Puerto Princesa Harbour. Transfers from Puerto Princesa Domestic Airport are included in the cruise package. If you require transportation from your hotel or resort to the embarkation point, Solitude can arrange it through a third-party transportation company, subject to applicable charges. The cost of transfers will vary depending on your location. It is recommended that you coordinate directly with your hotel/resort for a transfer to the embarkation point or to Puerto Princesa Domestic Airport Terminal, where our team can pick you up starting from 1400Hrs.

Upon boarding Solitude One, our friendly crew will warmly welcome you. Once welcomed, we will proceed with the orientation and registration process (don't forget to bring your C-Cards and/or Log Books!). To make the most of your time and ensure a smooth check-in, we encourage you to complete your registration and general liability release forms before boarding. However, if you haven't done so, there's no need to worry as you can fill them out after the orientation and hand them to your cruise directors. During the registration, we will also collect the necessary Permit and National Park fees. For detailed information on fees, please refer to our "Know-Before-You-Go" document. Dinner is included, and as the sun sets, Solitude One will begin its journey towards Tubbataha Reef National Park.

## A Note About the Dive Sites

To ensure a pleasant diving experience, the dive sites in Tubbataha Reefs will be carefully scheduled, taking into account tides, currents, and coordination with other liveaboards in the area. This approach helps prevent overcrowding at any specific dive site, allowing for a more enjoyable exploration of the underwater wonders. By considering these factors and communicating with other dive operators, we aim to provide a well-managed and uncrowded

diving environment, maximising your opportunities to discover the beauty of Tubbataha Reefs.

## Day 2, 3, 4 & 5

Gives the opportunity of a possible 3 or 4 dives per day at the North & South Atoll.

## Day 6

Gives the opportunity of a possible 2 dives at Jessie Beazley Reef.

In addition, please note that on DAY 6, it is crucial to follow our 18-hour no-fly/no-altitude policy. This means that your last dive should allow enough time before engaging in any activities involving flights or altitude. After completing the third dive on the final diving day, Solitude One will begin its return journey to Puerto Princesa, with an estimated travel time of 9 hours. This arrangement ensures a seamless transition back to the expedition's starting point.

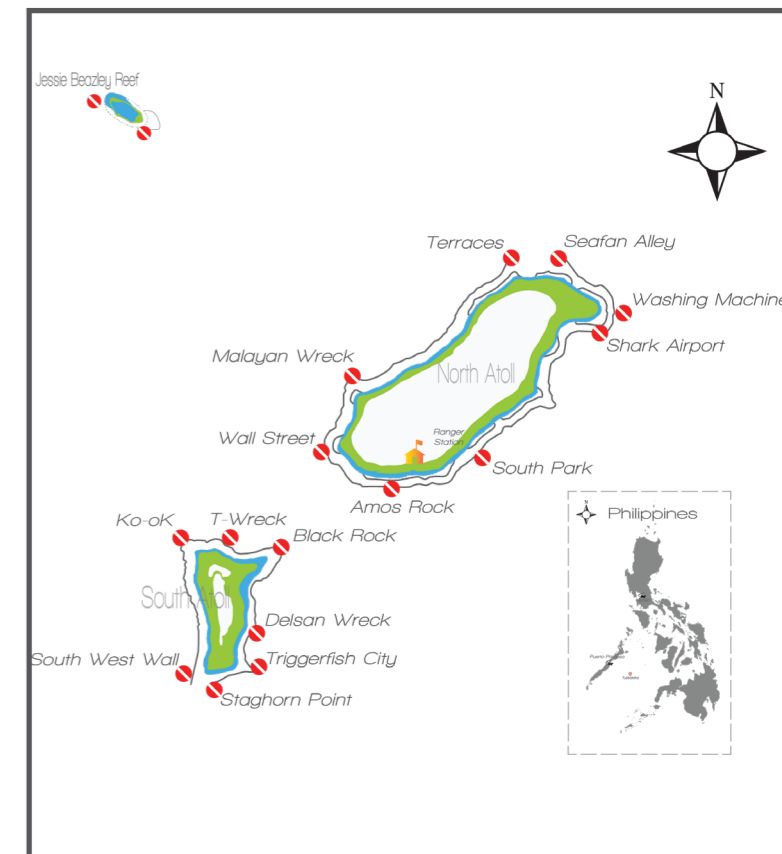

**Tubbataha Reefs  
National Park**

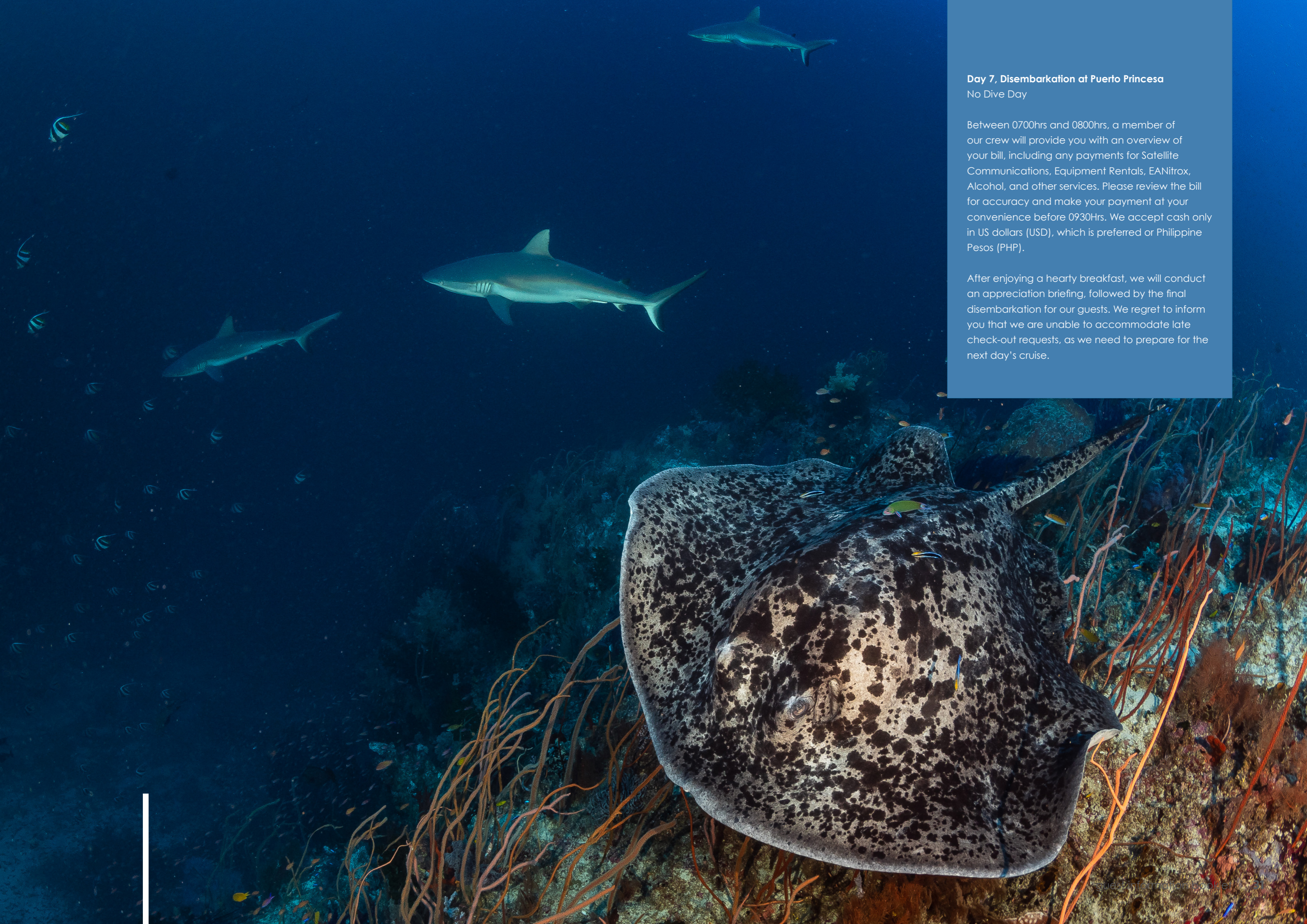

### Day 7, Disembarkation at Puerto Princesa

No Dive Day

Between 0700hrs and 0800hrs, a member of our crew will provide you with an overview of your bill, including any payments for Satellite Communications, Equipment Rentals, EANitrox, Alcohol, and other services. Please review the bill for accuracy and make your payment at your convenience before 0930Hrs. We accept cash only in US dollars (USD), which is preferred or Philippine Pesos (PHP).

After enjoying a hearty breakfast, we will conduct an appreciation briefing, followed by the final disembarkation for our guests. We regret to inform you that we are unable to accommodate late check-out requests, as we need to prepare for the next day's cruise.

# SOLITUDE WORLD

Liveaboard or Resort, we serve as your gateway to the Coral Triangle.

Solitude World is the ultimate destination for adventurers seeking to explore the pristine waters of the Coral Sea while enjoying the comforts of relaxed luxury.

We offer an extensive range of experiences, from encountering nudibranchs and unique critters to exploring bluewater reefs and big pelagics. Our three liveaboards, Solitude Adventurer, Solitude Gaia Palau and Solitude One, are carefully scheduled to coincide with the prime diving seasons in Raja Ampat, Banda Sea, Forgotten Island, Komodo, as well as in the Philippines and Palau.

Solitude Lembeh Resort is renowned as one of the critter capitals of the world, providing you with ample opportunity to explore from the black sand to the blue water, and even up to the local highlands.

We also offer Solitude Acacia Resort, located in the Philippines, which is the perfect destination for more macro critters especially nudibranchs and blackwater diving.

With Solitude World, you can rest assured that you will witness some of the world's most impressive marine creatures, and dive in the world's most abundant waters while experiencing the Solitude World's service and comforts.

## Liveaboards

### Solitude Adventurer

#### Indonesia

Embark on an extraordinary voyage of exploration and immersion into the untamed beauty of the Indonesian islands with the Solitude Adventurer. This remarkable catamaran, a masterpiece conceived and custom-built by Austal in Australia, invites you to discover the raw nature that thrives both above and below the waterline. Originally launched as a family yacht to commemorate the new millennium for a prominent Singaporean family, the Solitude Adventurer has undergone meticulous transformations to offer unparalleled hospitality and diving experiences.

Step aboard and be captivated by the sheer magnificence of this 36m (118ft) long and 12m (39ft) wide vessel. Bathed in natural light and featuring an abundance of space, the Solitude Adventurer ensures your utmost comfort as you embark on unforgettable cruises to Indonesia's most awe-inspiring destinations. Prepare to be enchanted by the untouched splendour of Komodo, the Forgotten Islands, Raja Ampat, and beyond.

Above the waterline, towering cliffs stand majestically, framing the rugged landscapes that beckon exploration. From breathtaking viewpoints, gaze upon the awe-inspiring vistas that unfold before your eyes, only witnessed by a fortunate few. Below the waterline lies a world of wonder, where vibrant coral reefs teem with an astounding array of marine life. Dive into crystal-clear waters and encounter the captivating beauty that resides beneath the surface.

The Solitude Adventurer has been meticulously outfitted to cater to your every need and desire. Each detail has been carefully considered, ensuring your journey is one of utmost comfort and indulgence. Immerse yourself in thoughtful amenities, relish delectable cuisine served in elegant surroundings, and unwind in spacious accommodations that blend modern elegance with a sense of tranquillity.

As you set sail on this extraordinary vessel, you embark on a voyage that transcends the ordinary. Discover the remote paradises of the Indonesian islands, where nature's wonders unfold in their purest form. Prepare to be enchanted, as the Solitude Adventurer invites you to experience a realm of untouched splendour and create memories that will last a lifetime.



Solitude Gaia Palau

Solitude Acacia Resort Anilao, the Philippines

Solitude Adventurer Indonesia

Solitude Lembeh Resort North Sulawesi, Indonesia

## Solitude Gaia Palau

### Palau

The Solitude Service on Solitude Gaia Palau embodies our dedication to crafting an exceptional liveaboard experience that seamlessly blends comfort, adventure, and communion with nature. Our team is committed to ensuring that every moment of your journey is marked by attentive care and exceptional service.

Upon boarding, you'll find yourself embraced by an environment where your needs are met with genuine warmth and a proactive approach. Our staff, well-versed in the art of hospitality, understands the distinct requirements of both scuba diving enthusiasts and travellers seeking a fusion of luxury and exploration.

Our culinary offerings epitomise our pursuit of excellence. Delight in carefully curated cuisine prepared with locally sourced ingredients, enhancing your dining experience. Whether dining under the stars or within our dining area,

each dish crafted by our culinary team promises a delightful journey for your palate.

Beyond the dining experience, our range of amenities and personalised services cater to your preferences. Whether it's engaging in water sports, indulging in a relaxing massage, or embarking on guided tours of underwater marvels, our team is dedicated to fulfilling your desires.

Our unwavering commitment to responsible and sustainable tourism ensures that your journey leaves a positive impact on the environment. We firmly believe in experiencing nature's beauty while actively safeguarding it, striving to minimise our ecological footprint.

The Solitude Service aboard Solitude Gaia Palau mirrors our passion for providing scuba divers and adventure enthusiasts with a world-class liveaboard experience. It's a service infused with warmth, expertise, and a deep commitment to environmental stewardship, ensuring that your journey is not just memorable but also purposeful.



## Resorts

### Solitude Acacia Anilao, The Philippines

Solitude Acacia, located in Anilao, The Philippines, has undergone a remarkable transformation. Formerly known as 'Acacia Resort and Dive Centre,' it partnered with Meseta Corp in 2018 to bring a fresh and contemporary design, elevating the resort to new levels of quality and professionalism under Solitude World's management. Our commitment is to provide an exceptional experience for our guests.

Immerse yourself in a breathtaking dining experience at our botanical restaurant, situated on the second level with 180° glass walls that offer panoramic views of the ocean and pool. Our modern and stylish restaurant provides the perfect setting to savour a variety of local and international cuisine. Whether you choose the

air-conditioned glass-walled area or the al fresco dining option, you'll be surrounded by the beauty of our resort.

Our fully equipped dive centre is designed to cater to divers of all levels, including beginners. With a contemporary and functional design, we offer courses and training in our spacious classroom that can accommodate up to 12 students. Additionally, our resort's swimming pool provides a convenient and safe environment for dive training.

Solitude Acacia Resort welcomes guests with 25 spacious and well-appointed rooms, featuring a fresh new contemporary design. Each room is thoughtfully crafted to blend modern aesthetics with the natural surroundings, ensuring a comfortable and stylish retreat amidst the tropical gardens.

## Solitude Lembeh Resort

### Lembeh Strait, Indonesia

Located on just over half a hectare in North Sulawesi, Indonesia, Solitude Lembeh Resort is a remarkable retreat that boasts a rich history of cherished friendships and enduring values. The resort's distinctive blend of cultures and fascinating past make it a truly one-of-a-kind destination. Guests can choose from two Seafront Villas, eight Garden Villas, and eight Deluxe Rooms, all designed to provide an authentic and comfortable experience. With a combination of traditional Indonesian architecture and modern amenities, each villa offers a cozy ambience where guests can easily unwind and relax. The resort's main goal is to create a peaceful and restorative haven for guests, giving them a chance to recharge and unwind. The Solitude team is dedicated to making every moment of guests' stay memorable, ensuring they leave with unforgettable and revitalising experiences.

Lembeh Strait, one of the most famous dive destinations in the world, is an absolute must for divers venturing to Indonesia.

Lembeh has become world renowned for its plethora and diversity of critters with many found only in the local area such as the Hairy Octopus or Lembeh Sea Dragon.

Divers can expect mild currents, low surge and shallow sites, making the area suitable for divers of all experience levels from a beginner to the veteran photographer. The water temperature varies depending on the time of the year, with the lowest being in July and August when the temperature drops to around 25°-26° degrees Celsius or 79°- 81° Fahrenheit. Please refer to page 8 for our Water Temperature Guide. To ensure your comfort we recommend that you bring a 3mm with a vest or a 5mm wetsuit, especially if you are planning on doing several long dives a day. We have additional layers for rent if you find you need more warmth.

Our primary focus is on macro and critters, so visibility is not typically a major concern for us. Nevertheless, it is worth noting that we occasionally encounter excellent visibility of up to 40 meters on the East of Lembeh, while inside the strait, the average visibility is around 10 meters.



CONTACT FORM



## CONNECT WITH US

Our team is thrilled and prepared to assist you in planning your next adventure with us. Keep in touch by scanning the QR codes and let the journey unfold.

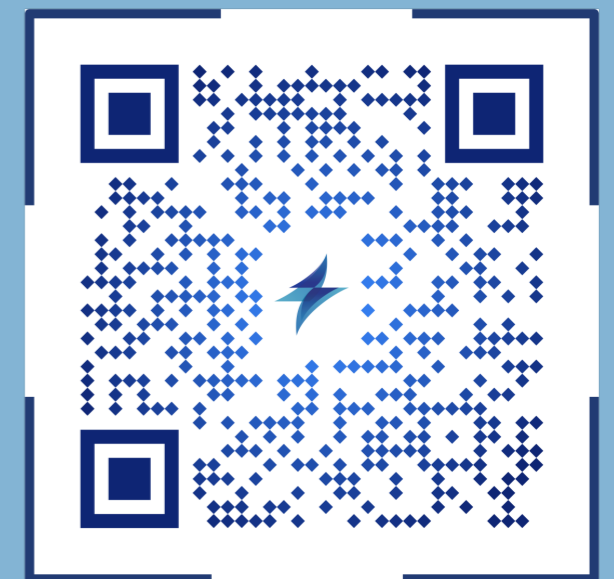

EMAIL US



# Join 3SIXTY & Enjoy Exclusive Solitude World Benefits.

Joining the **3SIXTY** program is complimentary and unlocks a world of opportunities with Solitude World for guests who book directly with us online or through the Solitude World reservations team. This program is our way of showing appreciation to our valued guests with exclusive benefits and privileges.

As a **3SIXTY** member, you'll effortlessly manage your personal information, access current and future bookings, and track your tier levels and benefits. You'll also have the opportunity to view and accept exclusive tokens of our appreciation, enjoy priority access to specials and promotions, and discover all the benefits available to you as a valued guest.

At Solitude World, your passion for travel, discovery, and hospitality is at the heart of everything we do. By joining the **3SIXTY** program, you'll unlock exclusive benefits that elevate your Solitude World Experience across all our destinations, making each adventure even more memorable. **3SIXTY** is designed to celebrate your journey and enrich every moment of your time with us - a Thank You for being part of our world.

To learn more about your **3SIXTY** benefits and how to register, visit our website or reach out to our friendly team.

[www.solitude.world](http://www.solitude.world)

FACEBOOK



INSTAGRAM



Come and join us on our social media platforms to keep in touch, stay informed and become part of a lively community.



WWW.SOLITUDE.WORLD

[www.solitude.world](http://www.solitude.world)